

SPECIFICATION

Current Rating: 3.0Amps/contact max.
 Contact Resistance: 20mΩ/contact max.
 Insulation Resistance: 1000M Ω Min
 Withstanding Voltage: 1500V AC for 1 minute
 Operating Voltage: 60V AC/DC
 Temperature Range: -40°C to +105°C

MATERIAL

Pin: Brass, machined
 Clip: Beryllium copper
 Plating(Pin): Tin 200u" over 80u"Nickel
 Plating(Clip): Gold flash over 80u" Nickel
 Insulator: PPS, UL94V-0, Black

ORDER INFORMATION

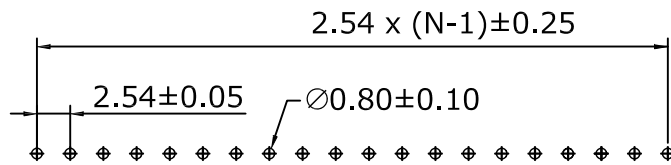
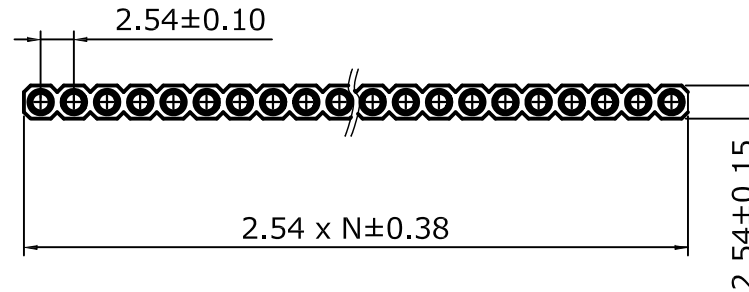
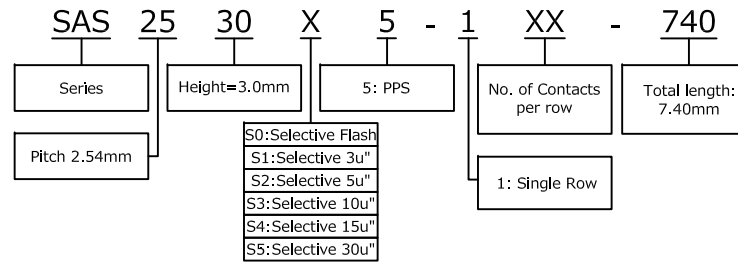

P.C.B LAYOUT

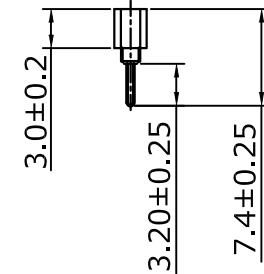
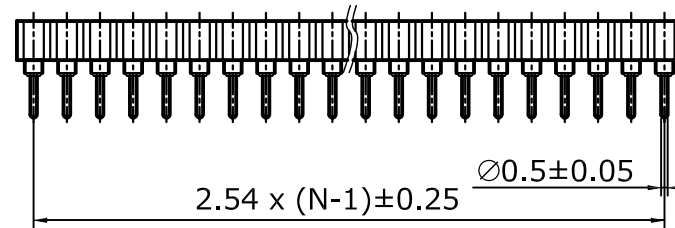

PART NO.	SAS2530X5-1XX-740	DRAWN	Andrew
DRAWING NO.	SAS2530X5-1XX-740	CHECKED	Claudia
DATE	2021/03/20	APPROVED	Brian

TITLE:	Machine pin socket 2.54mm	REV.	A0	TOLERANCE	.X ±0.25 .XX ±0.20	SCALE	1:1	UNIT	mm	NO.		DESCRIPTION		DATE	
--------	---------------------------	------	----	-----------	-----------------------	-------	-----	------	----	-----	--	-------------	--	------	--