

The reproduction, distribution and utilization of this document as well as the communication of its contents to others without express authorization is prohibited. Offenders will be held liable for the payment of damages. All rights reserved in the event of the grant of a patent, utility model or design.

17090M38T001

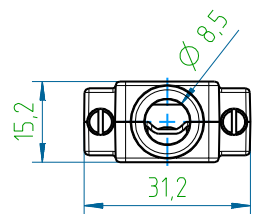
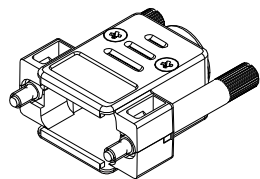
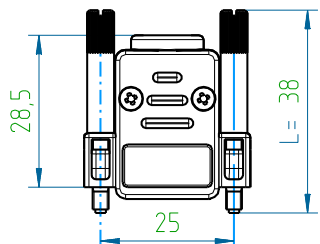

58098T

58094T

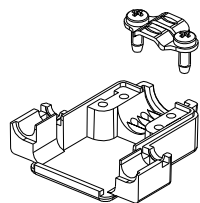
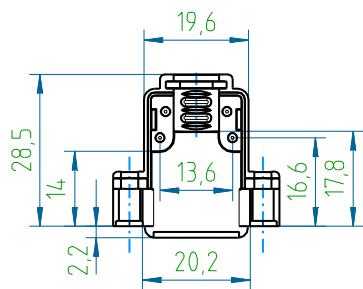
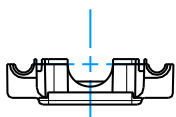
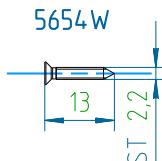
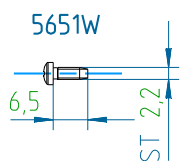

Verriegelungsschrauben / Locking screws 4-40 UNC:

55484N

55384N

55254N

55184N

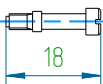
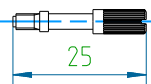
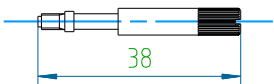
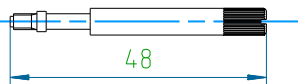

Verriegelungsschrauben / Locking screws M3:

55483N

55383N

55253N

55183N

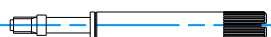

Nummernschlüssel / Numerical code: 17090BxxTVPE / 17090MxxTVPE:

B - ABS Sicoflex S469 UL94 V-0 E103497, roh / raw

M - ABS Polyac PA-765 UL94 V-0 E56070, Cu10/Ni5

xx - Länge der Verriegelungsschrauben / Length of locking screws 4-40 UNC, mm:
xx=48/38/25/18/00 (00 - ohne Verriegelungsschrauben / without locking screws)

Beispiel für M3 / Example of M3: 17090MxxM3TVPE

VPE - Verpackungseinheit 100 Stück / Packaging unit 100 pcs:

VPE=000 - als Schüttgut / as bulk

VPE=001 - als Set / as one hood packed as set

Zubehör - Werkstoff, Veredelung / Accessory - material, finishment:

58098T - Bandstahl / band steel, Cu2/Sn4

565xW - Einsatzstahl / case hardening steel, A3F DIN ISO 4042

55xx4N - Automatenstahl / machining steel, Cu2,5/Ni2,5

(solange Lagerbestand vorhanden / as available on stock: Cu2/Sn5)

Beispiel mit 58094T anstatt 58098T / Example with 58094T instead of 58098T: 17090MxxTAVPE

Kabeldurchmesser / Cable diameter: Dk=3-8,5 mm

(bei Dk=3-5 mm Kabelklemme wenden / if Dk=3-5 mm turn cable clamp)

17090B00T001	17090M00T001	-	7	8
17090B18T001	17090M18T001	18	10	11
17090B25T001	17090M25T001	25	11	12
17090B38T001	17090M38T001	38	16	17
17090B48T001	17090M48T001	48	19	20
Version B	Version M	L, mm	B	M
PVH-Artikel-Nr. / PVH-article no.		(xx)	Gewicht / weight, g	

55xx4N	55xx4N	2	Verriegelungsschraube / Locking screw
5654W	5654W	2	Blechschaube / Sheet metal screw
5651W	5651W	2	Blechschaube / Sheet metal screw
58098T	58098T	1	Kabelklemme / Cable clamp
17092B	17092M	1	Deckel / Cover
17091B	17091M	1	Gehäuse / Housing

17090BxxTVPE	17090MxxTVPE	Menge / Qty	Artikel-Bezeichnung / Article-name
PVH-Artikel-Nr. / PVH-article no.			

Toleranzen / Tolerances:	Projektion / projection:	Maßstab / scale:	Werkstoff / material:
DIN ISO 2768-m		1:1	Oberfläche cm² / surface cm²:
			Veredelung / refinement:
			Gewicht g / weight g:

Maßangaben in: dimension units:			mm	Benennung: name			
	Datum / date:	Name / name:	Kunststoffhaube Gr.1 Plastic hood Size 1				
	Bearb./drawn:	Strauch					
	Gepr./checked:	Straib					
05	Update	22.01.2014	Asf	Zeichnungs-Nr. / drawing no. 17090MXXTVPE-P			
04	Update	15.03.2013	Asf				
Index	Änderung / modification		Datum	Name	Kd.-Zg.:	Ersatz für / substitute to:	DIN A3

